

# Multi-Touch Overlay Kit

for BRAVIA® Professional Displays

Exclusive Use with BZ35F Series



10 Multi-touch points supported

Anti-fingerprint coating

Simple installation and set up

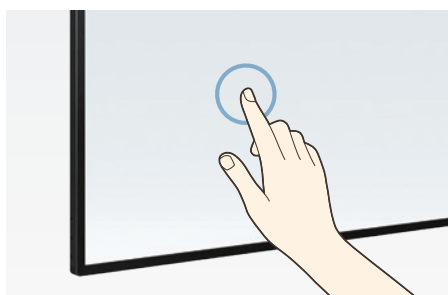
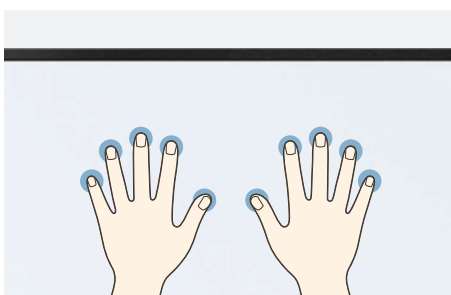



# Stylish & Smart Design

- » High quality design compatible with Professional BRAVIA Displays
- » Stylish bezel with uniform width
- » 19mm slim bezel  
※55"/65"
- » Advanced glass technology with lightweight design



Quality design and materials



# Customizable for Business Applications

- » Supports portrait installation  
※55"/65"/75"
- » Optimized for collaborative meeting room use with BRAVIA Meeting  
※Supports annotation function with Sony software



		STP-55IR100	STP-65IR100	STP-75IR100	STP-85IR100
TOUCH	Touch type	IR(Infrared Rays)Spread	IR(Infrared Rays)Spread	IR(Infrared Rays)Spread	IR(Infrared Rays)Spread
	Input Method	Finger, Pen and Opaque objects	Finger, Pen and Opaque objects	Finger, Pen and Opaque objects	Finger, Pen and Opaque objects
	Available object size for touch	Single touch 6mm,Multi touch 8mm	Single touch 6mm,Multi touch 8mm	Single touch 6mm,Multi touch 8mm	Single touch 6mm,Multi touch 8mm
	Response Time	<15ms	<15ms	<15ms	<15ms
	Frame Rate	125Hz	125Hz	125Hz	125Hz
	Touch Accuracy	±2mm(over 90% Area)	±2mm(over 90% Area)	±2mm(over 90% Area)	±2mm(over 90% Area)
	Interface	USB2.0	USB2.0	USB2.0	USB2.0
	Protection Glass Thickness	2.8mm	2.8mm	3.2mm	4.0mm
	Protection Glass Transmission	≥85%	≥85%	≥85%	≥85%
	Operating System Support	Windows 7 / 8 / 8.1 / 10 / Mac OS X (10.6 or later) / Android (4.0 or later) / Linux (Kernel 3.5 or later) / Chrome			
CONNECTIVITY	Multi touch point	10 Points	10 Points	10 Points	10 Points
	Touch Resolution	32767×32767	32767×32767	32767×32767	32767×32767
	Input	USB	USB	USB	USB
PHYSICAL SPECIFICATION	Average Current	<300mA	<300mA	<300mA	<300mA
	Working Voltage	DC 5V±5%	DC 5V±5%	DC 5V±5%	DC 5V±5%
	Color	Black	Black	Black	Black
	Material	Aluminum	Aluminum	Aluminum	Aluminum
	Bezel Width	19,0mm	19,0mm	20,5mm	25,1mm
	Overlay Dimension(W×H×D)	1252×723×31mm	1471×846×31mm	1696×974×34mm	1927×1108×28mm
	Weight(Head)	9,1Kg	11,6Kg	16,2Kg	24,6Kg
Carton Dimensions(W×H×D)	1366×815×140mm	1585×940×140mm	1808×1066×140mm	2040×1200×140mm	
Packed Weight	14,9Kg	18,8Kg	24,5Kg	34,3Kg	
INSTRUCTION MANUAL	Language	Arabic, Chinese, English, French, Japanese, Russian, Spanish, Vietnamese			
ENVIRONMENTAL CONDITIONS	Operation Temperature	0°C ~ 40°C	0°C ~ 40°C	0°C ~ 40°C	0°C ~ 40°C
	Operation Humidity	20% ~ 80%	20% ~ 80%	20% ~ 80%	20% ~ 80%
CERTIFICATION	FCC / CB / RCM / EAC / ICES / RoHS				
BUNDLED ITEM	Attachment Bracket / Instruction Manual				
ELECTRIC SUPPLY	USB Bus Power				

Sony Certified Products / Manufactured by Assist Corporation

©2019 Sony Electronics Inc. All rights reserved. Features and specifications are subject to change without notice. Reproduction in whole or in part without written permission is prohibited. Sony is a trademark of Sony Corporation. All other trademarks are the property of their respective owners.

www.sony.com/ProBRAVIA  
V-2678 (MK20221V2)

Issued in USA (3/19)